

# COMPACT series

## Hinge & mounting plate adjustments

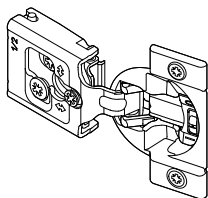

### COMPACT CLIP 30C2

Partial overlay hinge with CLIP mechanism and integrated soft-close

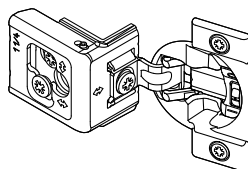

### COMPACT CLIP 31C1/31C3

Full overlay hinge with CLIP mechanism and integrated soft-close

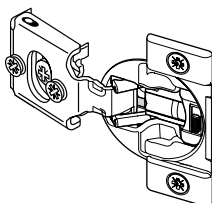

### COMPACT BLUMOTION 38N

Partial overlay one piece hinge with integrated soft-close

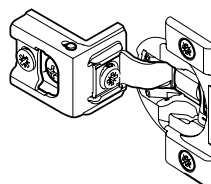

### COMPACT BLUMOTION 38C/39C

Full overlay one piece hinge with integrated soft-close

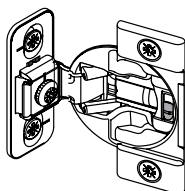

### COMPACT BLUMOTION 38B

Full overlay one piece facemount hinge with integrated soft-close

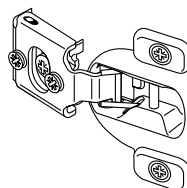

### COMPACT 38N

Partial overlay one piece hinge

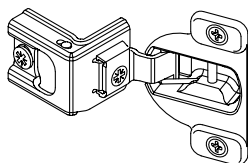

### COMPACT 38C/39C

Full overlay one piece hinge

# COMPACT CLIP 31C and 30C

## Cam Side Adjustment

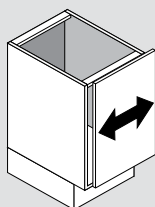

Rotate front cam screw to increase or decrease door overlay.

Range =  $\pm 1.5$  (1/16")

Full overlay

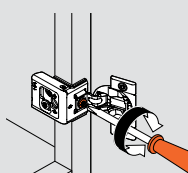

Partial overlay

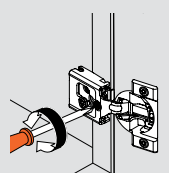

## Cam Height Adjustment

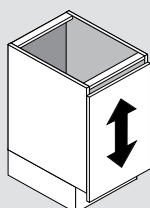

Rotate cam screw to increase or decrease door height.

Range =  $\pm 2$  (3/32")

Full overlay

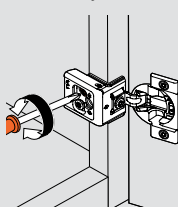

Partial overlay

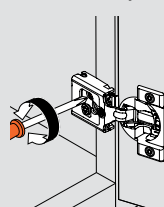

## Cam Depth Adjustment

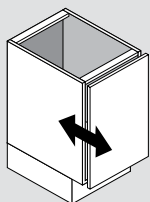

Rotate cam screw to adjust door gap.

Range =  
+ 2.5 (3/32")  
- 1 (1/32")

Full overlay

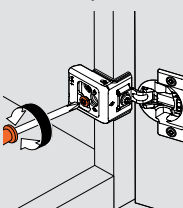

Partial overlay

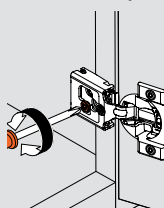

## COMPACT CLIP deactivation switch on the hinge cup

For small or light doors, the BLUMOTION can be deactivated on one of the hinges. Door must be closed once for deactivation to be complete. To reactivate, move the switch back to original position.

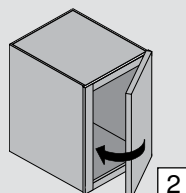
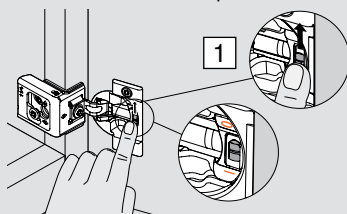

# COMPACT CLIP 31C and 30C

## Hinge removal

**STEP 1:** Locate CLIP release lever on back of hinge(A) and press down to release(B).

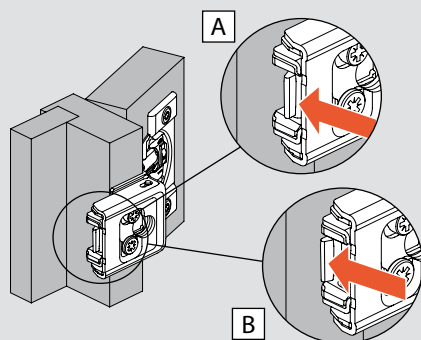

**STEP 2:** While the CLIP lever is released, pull forward on hinge to remove from cabinet.

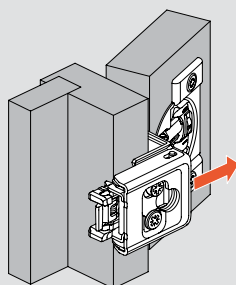

## Hinge attachment

**STEP 1:** Slide hinge onto CLIP plate until hinge clips in place.

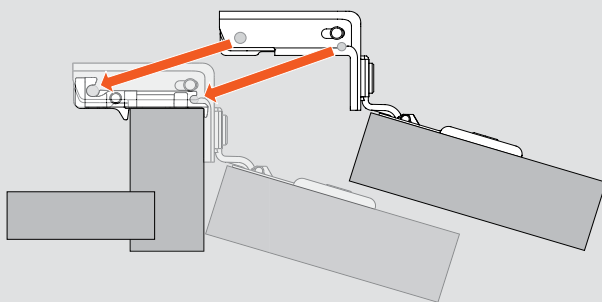

# COMPACT BLUMOTION and COMPACT 38C/39C and 38N

## Cam side adjustment

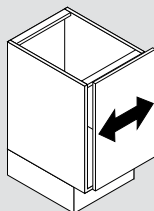

Rotate the front cam screw to increase or decrease door overlay.

Range =  $\pm 1.5$  (1/16")

Full overlay

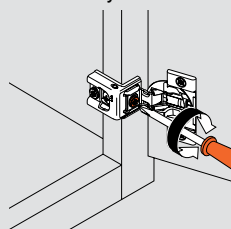

Partial overlay

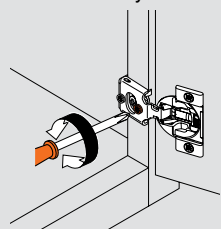

## Height adjustment

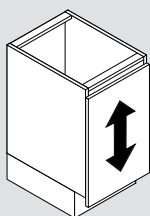

Loosen installation screws to adjust door position, and retighten.

Range =  $\pm 3$  (1/8")

Full overlay

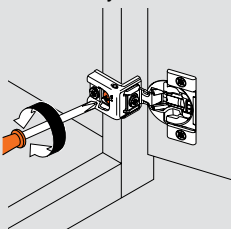

Partial overlay

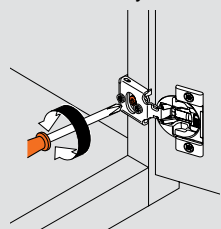

## Cam depth adjustment

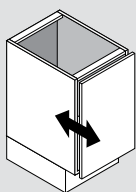

Rotate the rear cam screw to adjust door gap.

Range =  $\pm 2$ -1  
(+3/32"-1/32")

Full overlay

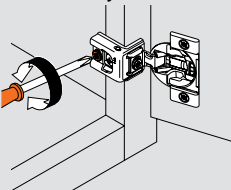

Partial overlay

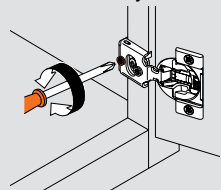

## Door removal

Loosen installation screws to remove hinge from cabinet.

Full overlay

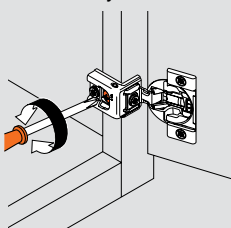

Partial overlay

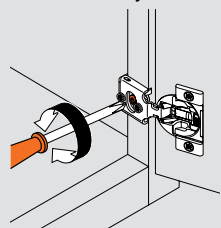

# COMPACT BLUMOTION 38B

## Height adjustment

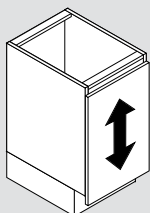

Loosen installation screws to adjust door position, and retighten.

Range =  $\pm 2$  (3/32")

Facemount

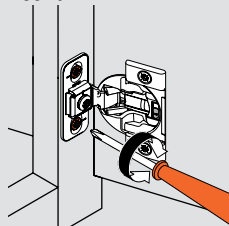

## Cam side adjustment

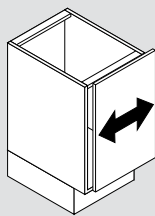

Rotate the front cam screw to increase or decrease door overlay.

Range =  $\pm 1.6$  (1/16")

Facemount

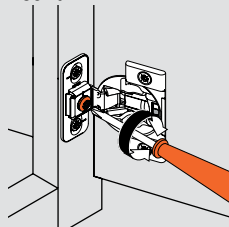

## Door removal

Loosen installation screws to remove hinge from cabinet.

Facemount

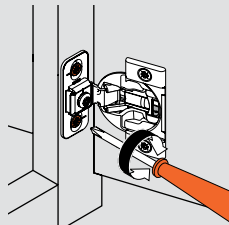

# COMPACT BLUMOTION 38C/39C, 38B and 38N

## COMPACT BLUMOTION deactivation switch on the hinge cup

For small or light doors, the BLUMOTION can be deactivated on one of the hinges. COMPACT BLUMOTION comes in the activated position "I". Deactivated is "0".

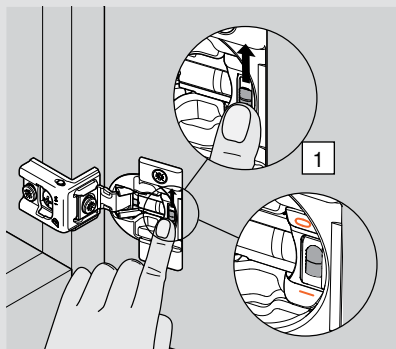

Door must be closed once for the deactivation to be complete. To reactivate, move switch back to original position "I".

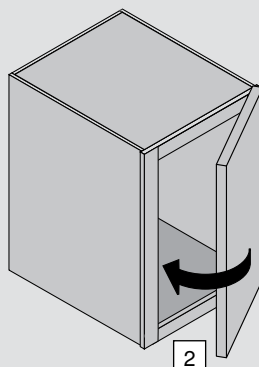

## Suggested tool for installation and adjustment

### POZI DRIVER and bits

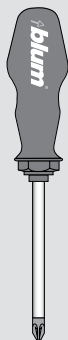

A POZI screwdriver (different from Phillips) is the most crucial tool you can use to assure that full torque is applied to all Blum mounting screws. POZI screws can be identified by the distinctive "tick" marks located in the center of the screw head recess.

